

w Baniach Mazurskich

PROJEKT ZAGOSPODAROWANIA TERENU

ojślaw	SUV-52/91	STADIUM: PROJEKT BUD.-WYK.
--------	-----------	-------------------------------

DATA:
maj 2017 r.

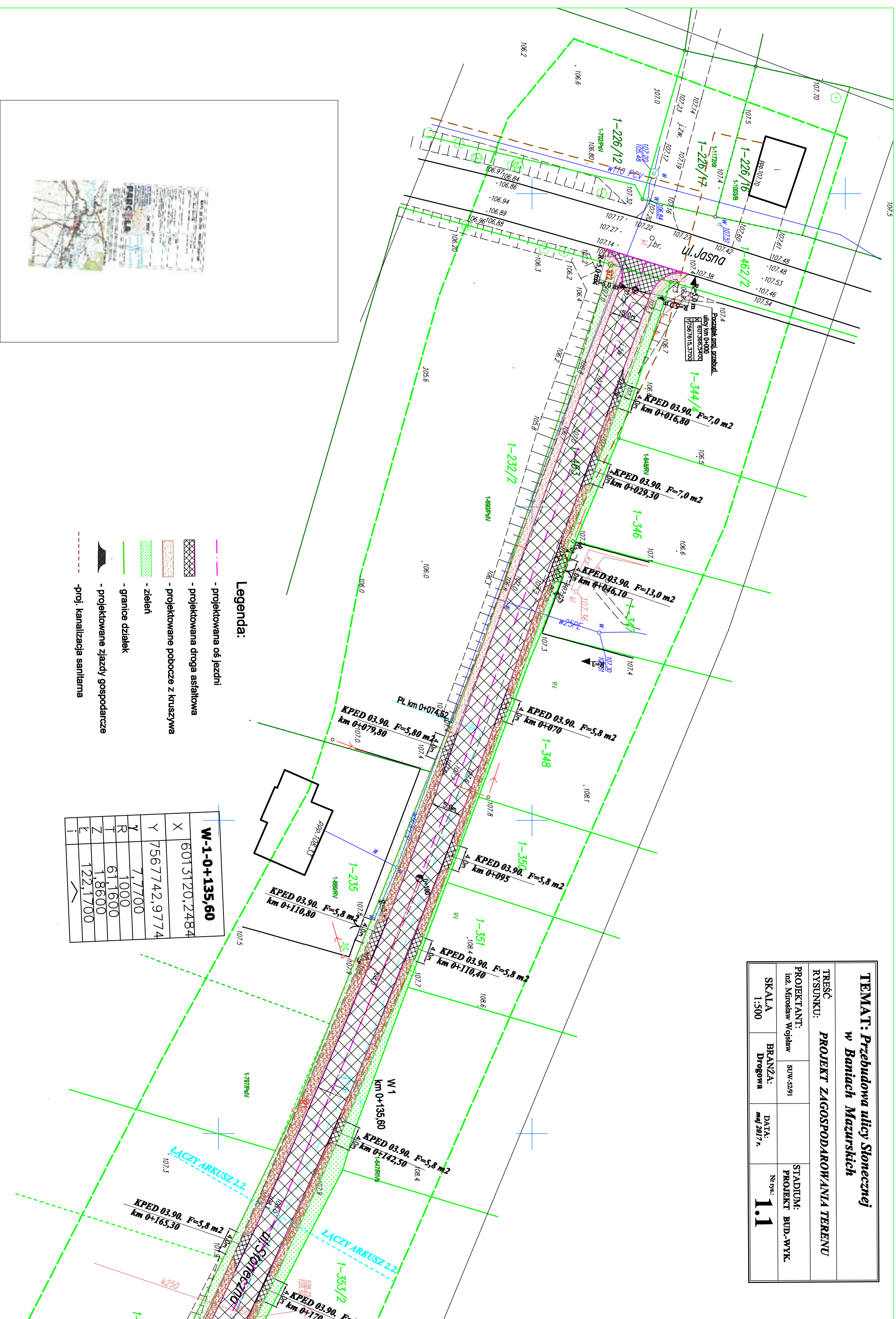

W-1-O+135,60	
X	6013120,2484
Y	7567742,9774
Y	7,7700
R	1000
T	61,1600
Z	1,8600
L	122,1700
I	↗